

Shaft dia. mm inch	Unit number	Nominal dimensions									Bolt size mm inch	Bearing number	Housing number	Mass of unit Kg
		mm inch												
		<i>a</i>	<i>e</i>	<i>i</i>	<i>g</i>	<i>t</i>	<i>s</i>	<i>z</i>	<i>Bi</i>	<i>n</i>				
12 1/2	UEL201	86	64	15	12	25.5	12	41.5	43.5	17.0	M 10	UEL 201	F 204	0.63
	UEL201-8	3-25/64	2-3/64	19/32	15/32	1	15/32	1-41/64	1.7126	0.6693	3/8	UEL 201-8		0.63
15 5/8	UEL202	86	64	15	12	25.5	12	41.5	43.5	17.0	M 10	UEL 202	F 204	0.61
	UEL202-10	3-25/64	2-3/64	19/32	15/32	1	15/32	1-41/64	1.7126	0.6693	3/8	UEL 202-10		0.61
17 11/16	UEL203	86	64	15	12	25.5	12	41.5	43.5	17.0	M 10	UEL 203	F 204	0.60
	UEL203-11	3-25/64	2-3/64	19/32	15/32	1	15/32	1-41/64	1.7126	0.6693	3/8	UEL 203-11		0.60
20 3/4	UEL204	86	64	15	12	25.5	12	41.5	43.5	17.0	M 10	UEL 204	F 204	0.58
	UEL204-12	3-25/64	2-3/64	19/32	15/32	1	15/32	1-41/64	1.7126	0.6693	3/8	UEL 204-12		0.59
25 1	UEL205	95	70	16	13	27.0	12	42.9	44.3	17.4	M 10	UEL 205	F 205	0.78
	UEL205-16	3-47/64	2-3/4	5/8	3/64	1-1/16	15/32	1-11/16	1.7441	0.6850	3/8	UEL 205-16		0.77
30 1-1/8 1-1/4	UEL206	108	83	18	13	31.0	12	48.1	48.3	18.2	M 10	UEL 206	F 206	1.14
	UEL206-18											UEL 206-18		1.16
	UEL206-20	4-1/4	3-17/64	45/64	3/64	1-7/32	15/32	1-57/64	1.9016	0.7165	3/8	UEL 206-20		1.11
35 1-1/4 1-3/8	UEL207	117	92	19	15	34.0	14	51.3	51.1	18.8	M 12	UEL 207	F 207	1.47
	UEL207-20											UEL 207-20		1.55
	UEL207-22	4-39/64	3-5/8	3/4	19/32	1-11/32	35/64	2-1/64	2.0118	0.7402	7/16	UEL 207-22		1.48
40 1-1/2	UEL208	130	102	21	15	36.0	16	55.9	56.3	21.4	M 14	UEL 208	F 208	1.91
	UEL208-24	5-1/8	4-1/64	53/64	19/32	1-27/64	5/8	2-13/64	2.2165	0.8425	1/2	UEL 208-24		1.96
45 1-5/8 1-3/4	UEL209	137	105	22	16	38.0	16	56.9	56.3	21.4	M 14	UEL 209	F 209	2.22
	UEL209-26											UEL 209-26		2.33
	UEL209-28	5-25/64	4-9/64	55/64	5/8	1-1/2	5/8	2-15/64	2.2165	0.8425	1/2	UEL 209-28		2.24
50 1-7/8	UEL210	143	111	22	16	40.0	16	60.1	62.7	24.6	M 14	UEL 210	F 210	2.56
	UEL210-30	5-5/8	4-3/8	55/64	5/8	1-37/64	5/8	2-23/64	2.4685	0.9685	1/2	UEL 210-30		2.65
55 2	UEL211	162	130	25	18	43.0	19	68.6	71.4	27.7	M 16	UEL 211	F 211	3.27
	UEL211-32	6-3/8	5-1/8	63/64	45/64	1-11/16	3/4	2-45/64	2.8110	1.0906	5/8	UEL 211-32		3.46
60 2-1/4	UEL212	175	143	29	18	48.0	19	75.8	77.8	30.9	M 16	UEL 212	F 212	3.91
	UEL212-36	6-57/64	5-5/8	1-9/64	45/64	1-57/64	3/4	2-63/64	3.0630	1.2165	5/8	UEL 212-36		4.07
65 2-1/2	UEL213	187	149	30	22	50.0	19	81.6	85.7	34.1	M 16	UEL 213	F 213	5.47
	UEL213-40	7-23/64	5-55/64	1-3/16	55/64	1-31/32	3/4	3-7/32	3.3740	1.3425	5/8	UEL 213-40		5.57
70 2-3/4	UEL214	193	152	31	22	54.0	19	82.6	85.7	34.1	M 16	UEL 214	F 214	6.14
	UEL214-44	7-19/32	5-63/64	1-7/32	55/64	2-1/8	3/4	3-1/4	3.3740	1.3425	5/8	UEL 214-44		6.15

Remark: 1) Regular production in "J" tolerance.
 2) Bearing unit with grease holes and grease groove.
 3) Bearing unit without stop pin.

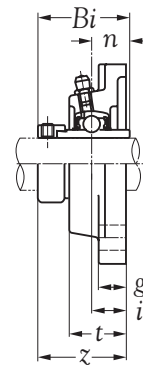
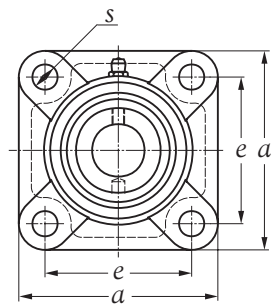

Shaft dia. mm inch	Unit number	Nominal dimensions									Bolt size mm inch	Bearing number	Housing number	Mass of unit Kg
		<i>a</i>	<i>e</i>	<i>i</i>	<i>g</i>	<i>t</i>	<i>s</i>	<i>z</i>	<i>Bi</i>	<i>n</i>				
75	UELF 215	200	159	34	22	56.0	19	88.8	92.1	37.3	M 16	UEL 215	F 215	6.18
3	UELF 215-48	7-7/8	6-17/64	1-11/32	55/64	2-13/64	3/4	3-1/2	3.6260	1.4685	5/8	UEL 215-48		6.08

- Remark: 1) Regular production in "J" tolerance.
 2) Bearing unit with grease holes and grease groove.
 3) Bearing unit without stop pin.